

1-Patch and float ceiling at wall deletions
 2-Patch in floor with Vinyl tile
 Accent color at patched areas
 in kitchen only

Community Center
 2 Nice Guys, Inc

Eliminate door option

No uppers

Consider a rolling cart at 24"x60"?

Relocate wall oven

Hinged counter

Delete door and frame/studs at latch side

single access door (cabinet material)
 for dead space

Move mechanical room wall in
 toward kitchen by 10"

New Panel

No new flooring
 No AH work

A/H

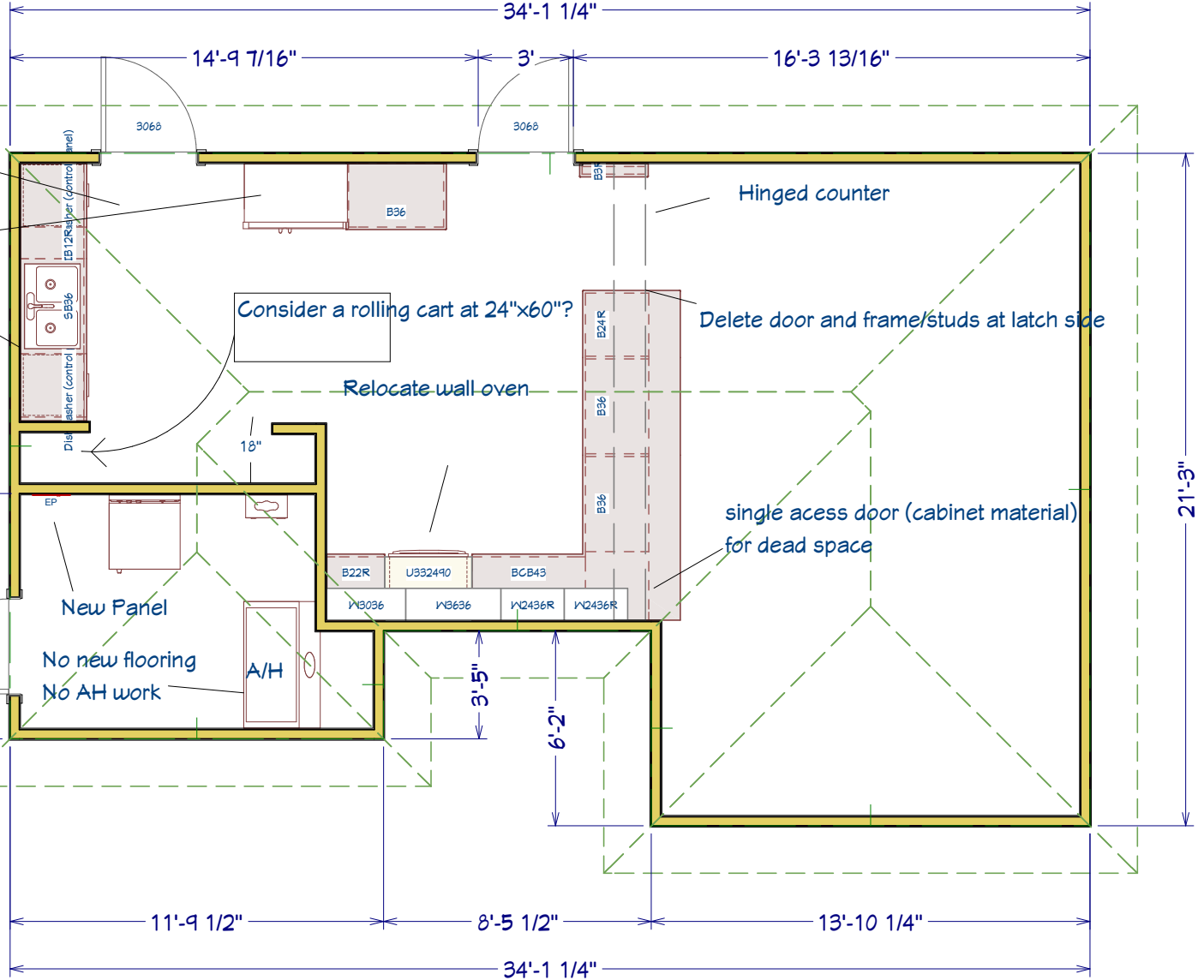

LIVING AREA
 640 SQ FT